

Ecco una pratica guida per installare in quattro semplici step un impianto centralizzato nella tua abitazione.
Here is a practical guide to install a centralized system in your home in four simple steps.

1 PROCURA IL MATERIALE CHE TI SERVE / GET THE MATERIALS YOU NEED

UTENSILI / TOOLS



Trapano
Drill



Cacciavite
Screwdriver



Compasso
Compass



Forbici
Scissors



Tasselli
Dowels



Morsetti
Clamps

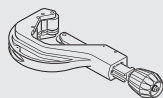

Tagliatubi
Pipe cutters

MATERIALI D'INSTALLAZIONE / INSTALLATION MATERIALS



Contropresa
Mounting plate



Presa aspirante rettangolare o quadrata
Rectangular or square inlet

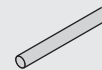

Tubo PVC
PVC pipe



Deviazione FF
FF derivation



Manicotto
Sleeve



Curva M/F
M/F elbow



Curva F/F
F/F elbow



Colla speciale
Special glue



Griglia di sfiato
Air vent







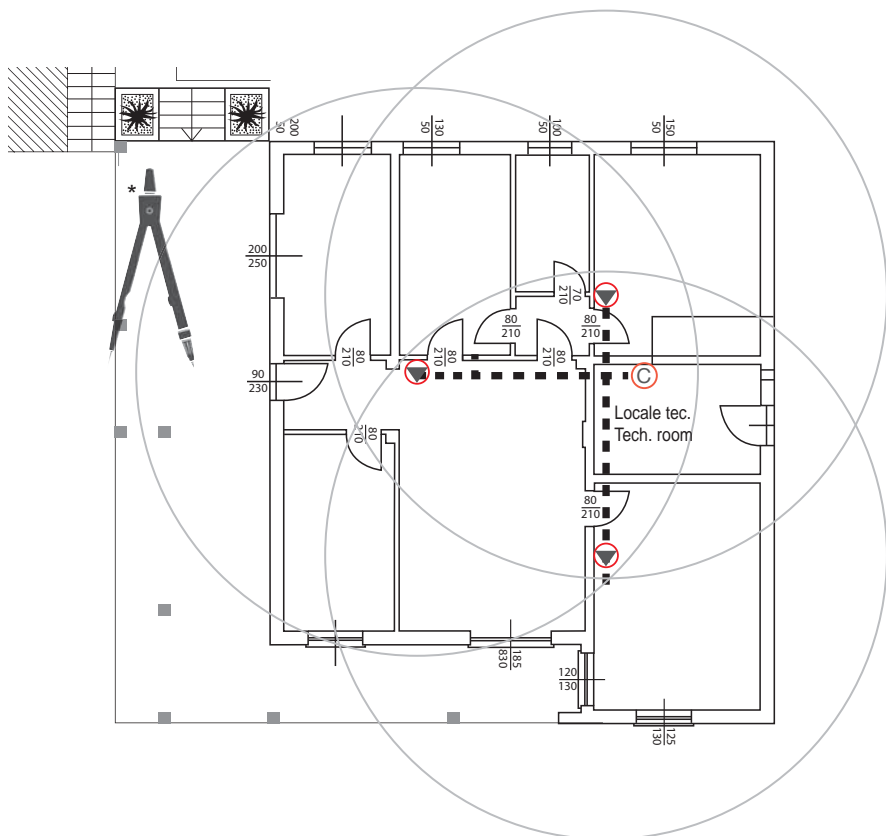

Guaina elettrica
Prewired cable

2 DEFINISCI DOVE INSTALLARE LE PRESE ASPIRANTI / DEFINE WHERE TO INSTALL THE VACUUM INLETS





N.B. Ricorda che 1 punto presa copre circa 35/40 mq e che hai a disposizione 1 tubo flessibile di 9 metri.

N.B. Remember that 1 inlet covers about 35/40 square meters and that you have 1 flexible hose of 9 meters at your disposal.

- *  Raggio = 7 m ~ 1 punto presa  35 m²
 Raggio = 9 m ~ 1 punto presa  40 m²
 Radius = 7 m ~ 1 Inlet point  35 m²
 Radius = 9 m ~ 1 Inlet point  40 m²

LEGENDA/KEY

	Presa aspirante / Vacuum inlet
	Centrale aspirante / Central vacuum unit
	Rete tubiera / Pipe network 50 mm

Per qualsiasi necessità, richiesta di preventivo o consulenza tecnica, non esitare a contattarci!
For any need, request for a quote or technical advice, do not hesitate to contact us!

3 REALIZZA LA RETE TUBIERA / INSTALL THE PIPE NETWORK

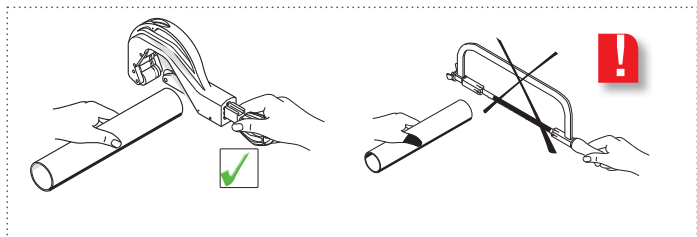

Utilizza l'apposito tagliatubi ed evita di utilizzare il seghetto o altri strumenti non idonei.

Use the appropriate pipe cutter and avoid using the hacksaw or other unsuitable tools.

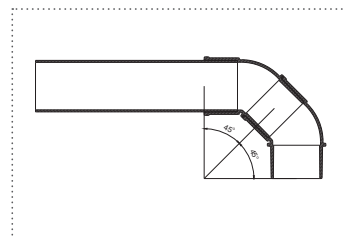
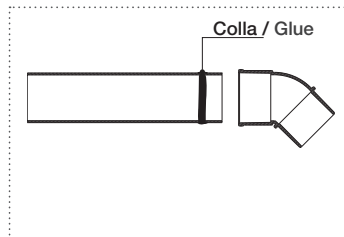

Ricorda che la colla va sempre sul maschio e che per fare una curva da 90° puoi unire due curve da 45°.

Remember that the glue always goes on the male and that to make a 90° elbow you can join two 45° elbows.

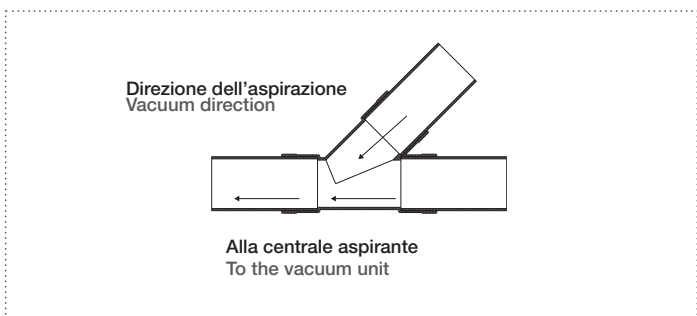

Fai attenzione al senso della derivazione: le frecce indicano la direzione dell'aria verso la centrale aspirante.

Pay attention to the direction of the branch: the arrows indicate the direction of the air towards the central vacuum unit.

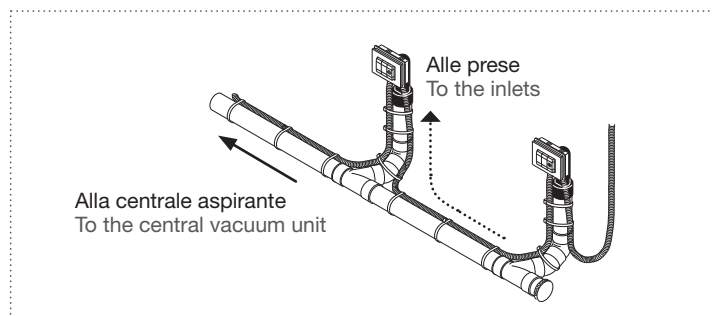

Una volta collegate in parallelo le varie prese con la guaina preinfilita, arrivare con un unico cavo alla centrale aspirante e collegarlo al cavo di uscita denominato "micro".

Once the various inlets have been connected in parallel with the pre-threaded sheath, reach the central vacuum unit with a single cable and connect it to the output cable called "micro".

4 COLLEGA LE PRESE ASPIRANTI E LA CENTRALE / CONNECTS VACUUM INLETS AND CENTRAL VACUUM UNIT

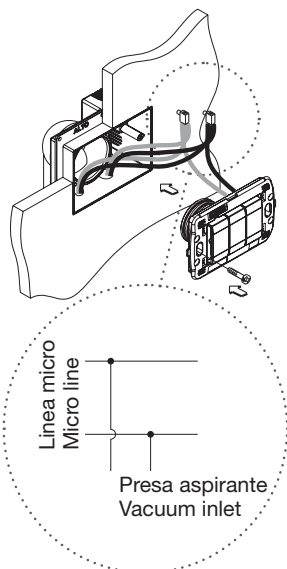

Unisci i cavi elettrici nei morsetti già pre-cablati per la connessione elettrica delle prese aspiranti.

Join the electrical cables in the pre-wired terminals for the electrical connection of the vacuum inlets.

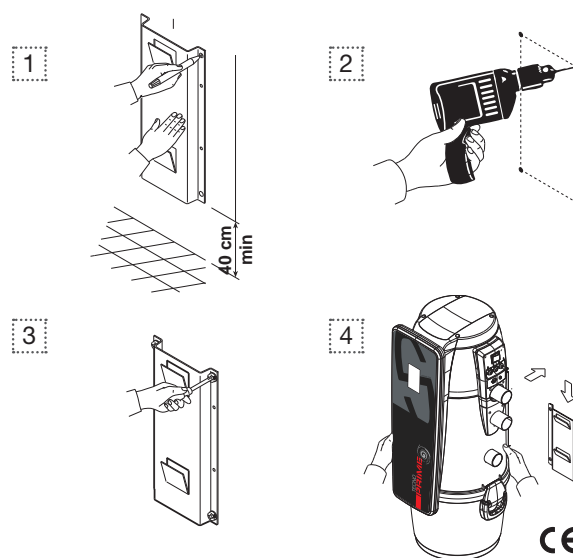

Fissa la dima alla parete con i tasselli ad almeno 40 cm da terra e aggancia la centrale aspirante.

Fix the template to the wall with dowels at least 40 cm from the ground and attach the central vacuum cleaner.

PRIMA DI METTERTI AL LAVORO, COSTRUISCI IL TUO CAPPELLINO!
BEFORE YOU GET DOWN TO WORK, MAKE YOUR OWN HAT!

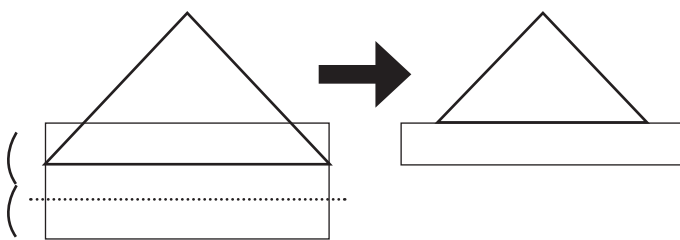
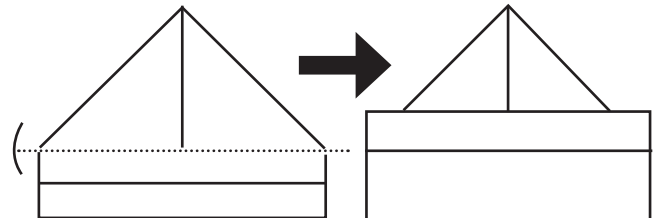
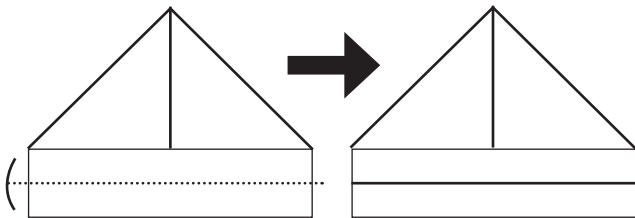
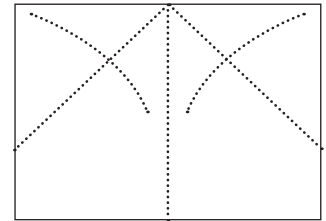
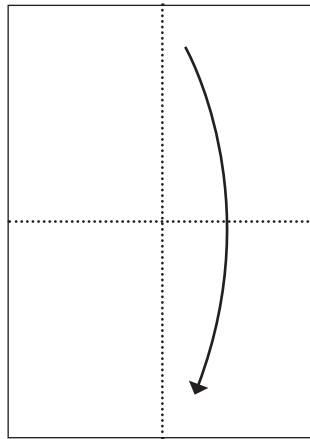
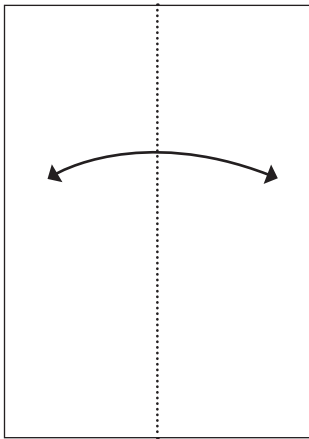

CENTRAL VACUUM SYSTEMS

